

Hospital Bottle Warmer

Quick-Start-Guide



Do not pour in any water!



Place bottle inside.



Put cover on device.



Press button until the corner lights up blue. In the warming phase, the lamps in the device turn on and off several times.



When the feeding temperature has been reached, the corner lights up green.



If required, remove cover and take out bottle, or continue to keep it warm in the device (max. 120 min.).

Options

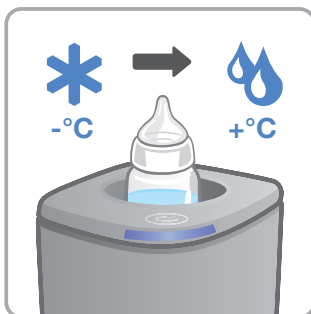

Thawing: A sensor detects whether the contents of the bottle or syringe have frozen and automatically starts a gentle thawing process. The corner lights up purple.

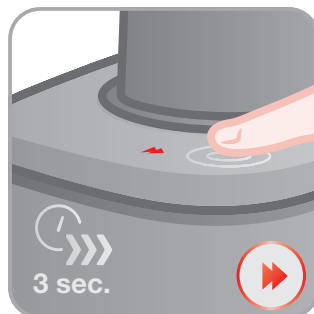

If you need it quickly: Press button for 3 seconds to activate boost mode. Lamp lights up red. To switch off, press button until the red light goes out.

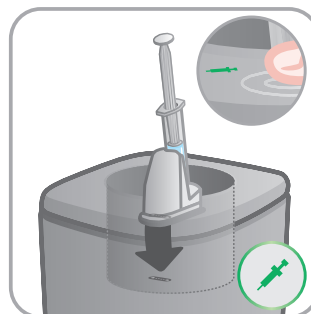

Warm syringe in syringe holder (available separately). Contacts of holder and device base connect. Lamp lights up green.



If there is a red light, the food is too warm. If there is a red flashing light, there is a device error. See information in the instructions for use.



MEDICPRO
MAPA CLINICAL SUPPORT